

1 2 3 4 5 6 7 8 9 10

A
B
C
D
E
F

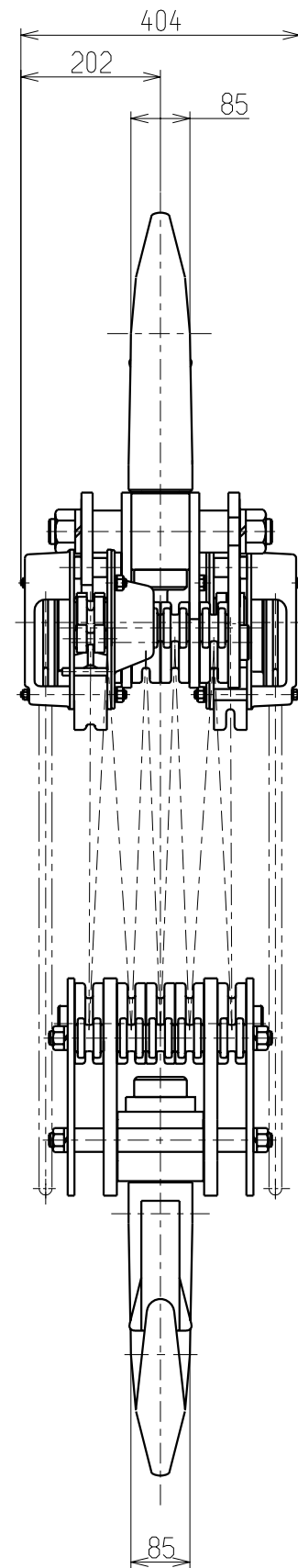
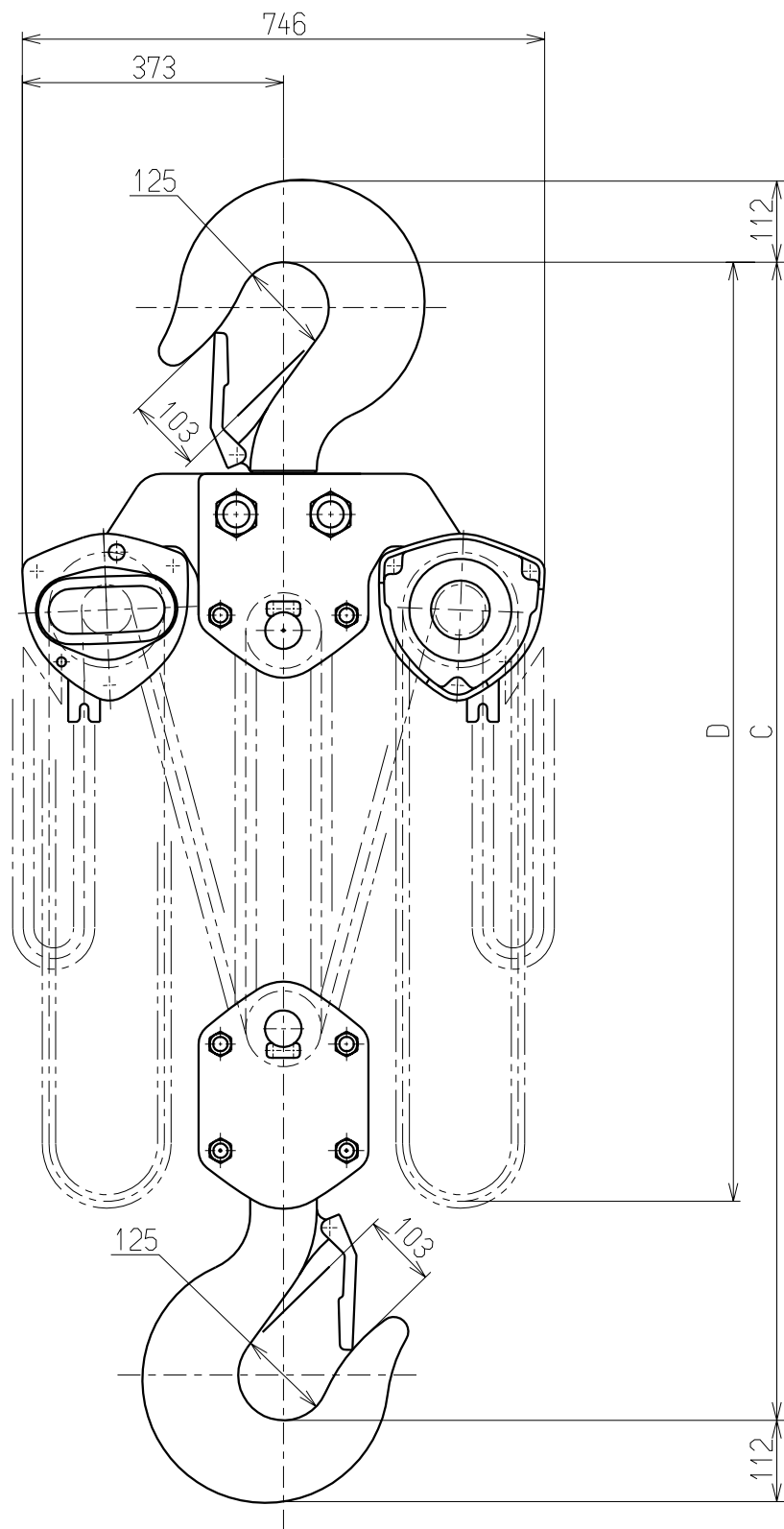

Particulars		
Nominal Capacity	30 t	
Lift	3.5 m	
Min. Headroom : C	1300 mm	
Chain Pull to Lift Full Load	421×2 N (43×2 Kg)	
Hand Chain	Folded Length	4.5 m
	Length from Top Hook : D	4.8 m
Mass	310 kg	

Note:

APPROVED	CHECKED	DESIGNED
FUKASAWA 2001.5.23	ARUGA 2001.5.23	IINUMA 2001.5.23

30 t CB SERIES CHAIN HOIST			
CODE	CB300	SCALE	~
DWG.NO.	C3BA300-12100	DATE	△

KITO CORP.

UNIT : mm